

# FLOS

F0300000 Steel

## Arco

Designed by Achille and Pier Giacomo Castiglioni, 1962

Halogen - 70W

Floor lamp emitting direct light via a perforated aluminium diffuser mounted on a stainless-steel telescopic stem. Swivelling and height-adjustable reflector made from pressed, polished and zapon-varnished aluminium. A white Carrara marble base acts as a counterbalance and features a hole to allow for transport with a wooden pole.

Are you a professional and your project needs consulting and support?

BOOK AN APPOINTMENT

### Main specifications

EAN	8059607000946
Mounting	Floor
Environments	Indoor dry location
Light source type	Bulb
Light sources included	No
Lamp category	Halogen
Lamp holders	E27
Ilcos	HSGSA/S
Number of lamps	1
Power (W)	70

### Physical

Colour	Steel
Length (mm)	2200
Cord colour	Black
Cord length (mm)	2500
Net weight (kg)	63.4
Package volume (m3)	0.13
IP internal	20

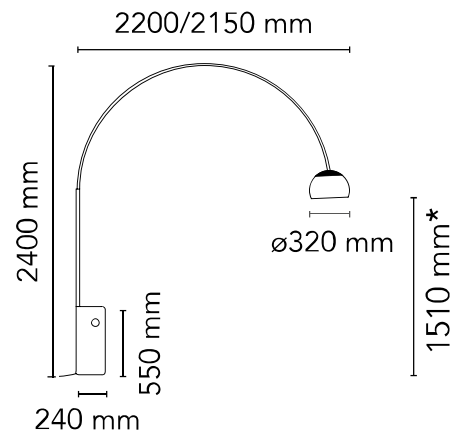
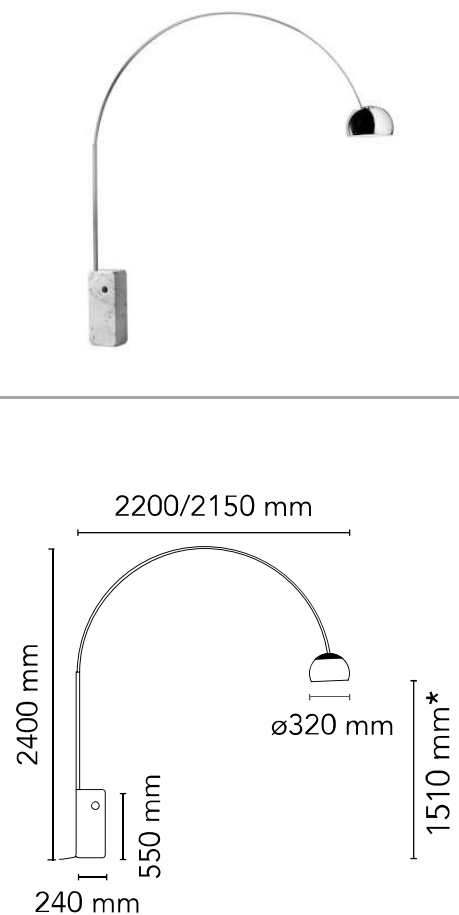

\*The diffuser can be adjusted to 1700 mm or 1850 mm.

### Download

Mounting instructions [Download PDF](#)

Mounting instructions [Download PDF](#)



Schematic light drawing

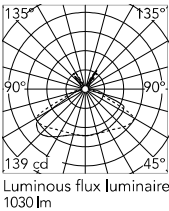

Photometric

Lighting type	Direct
Light distribution	Asymmetric
Extreme cut off	No

Electrical

Insulation class	II
Frequency (Hz)	50/60
Main voltage (Vac)	220-250
Plug type	Type C
Batteries inside	No

## Bulbs

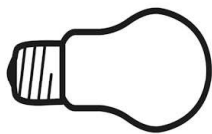

NOT INCLUDED

RF32771

LED Lamp 11W Im E27 220-  
240V 2700K A60

Spare Parts

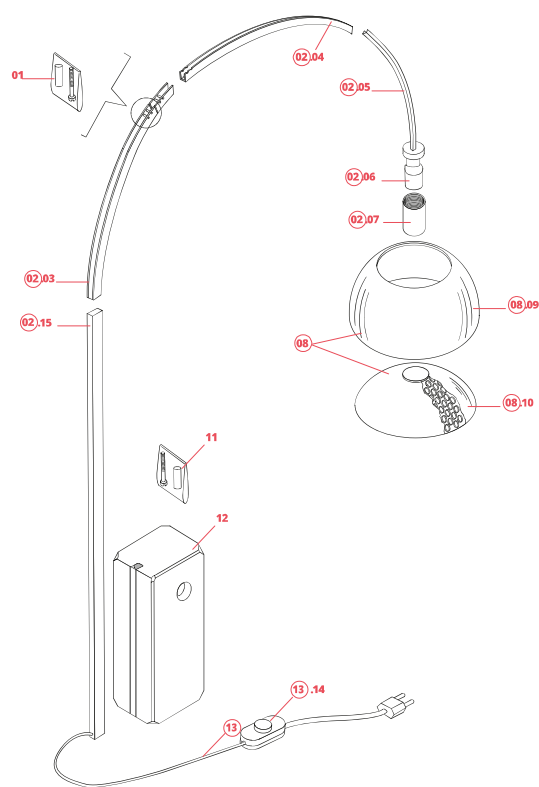

01.	Pins and screw set	RF0300200
02.	Arco Stem and channels Enec assembly with on/off switch	F0330000
03.	Long inox channel	RF02970
04.	Medium inox channel	RF02971
05.	Small inox channel with lamp holder integrated	RF02972
06.	Arco Lamp holder with joint	RF0300300
07.	Arco Anodized sleeve	RF02593
08.	Arco Enec reflector and grid	F0320000
09.	Polished reflector	RF00797
10.	Arco Polished grid	RF01411
11.	Fixing screw with joint	RF0300100
12.	Marble base	F0310000
13.	Arco Electrical wiring assembly with on-off switch	RF04724
14.	Black d/661 on-off switch	RF04392
15.	Inox stem	RF21041



RF0300200

Pins and screw set

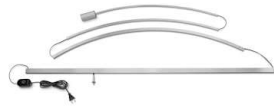

F0330000

Arco Stem and channels EneC assembly with on/off switch



RF02970

Long inox channel



RF02971

Medium inox channel



RF02972

Small inox channel with lamp holder integrated



RF0300300

Arco Lamp holder with joint



RF02593

Arco Anodized sleeve



F0320000

Arco EneC reflector and grid



RF00797

Polished reflector



RF01411

Arco Polished grid



RF0300100

Fixing screw with joint



F0310000

Marble base



RF04724

Arco Electrical wiring assembly  
with on-off switch



RF04392

Black d/661 on-off switch



RF21041

Inox stem

# FLOS

F0303000 Steel

## Arco Led

Designed by Achille and Pier Giacomo Castiglioni, 1962

28W - 1224lm - 2700K

Floor lamp providing direct light. White Carrara marble base. Satin-finish stainless steel telescopic stem. Pressed, polished and zapon-varnished aluminum swiveling and height-adjustable reflector.



Are you a professional and your project needs consulting and support?

BOOK AN APPOINTMENT

### Main specifications

EAN	8059607000991
Mounting	Floor
Environments	Indoor dry location
Light source type	LED
Light sources included	Yes
LED type	LED array
Power (W)	28
Lumen Output (lm)	1224

### Physical

Colour	Steel
Length (mm)	2200
Cord colour	Black
Cord length (mm)	2300
Net weight (kg)	63.85
Package volume (m3)	0.24
IP internal	20

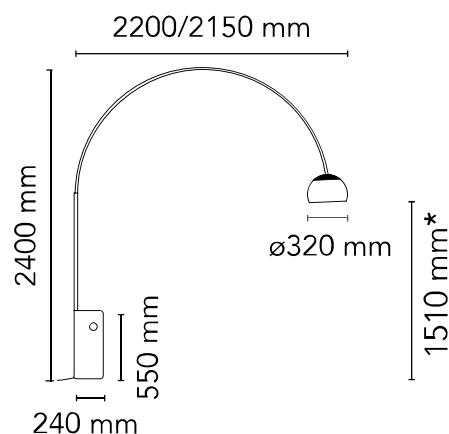

\*The diffuser can be adjusted to 1700 mm or 1850 mm.

### Download

Mounting instructions	↓ PDF
Mounting instructions	↓ PDF
Mounting instructions	↓ PDF

### Photometric Files

LDT / IES	↓ LDT
-----------	-------

### Technical Drawings

2D	↓ ZIP
3D	↓ ZIP
Bim	↓ ZIP

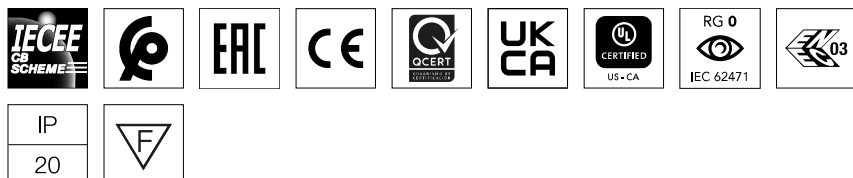

Schematic light drawing

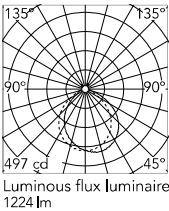

Photometric

Lighting type	Direct
Light distribution	Asymmetric
CCT (K)	2700
Extreme cut off	No

Electrical

Insulation class	III
Frequency (Hz)	50/60
Main voltage (Vac)	100-240
Power supply	Remote included
Dimmable	Yes
Power supply type	Electronic 48V
Dimming interface	Dimmer Integrated
Plug type	Type G, Type A, Type C
Batteries inside	No

Ecodesign and Energy Labelling

This product contains a light source of energy efficiency class D

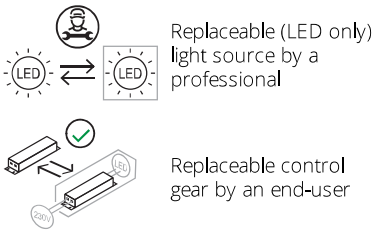



Spare Parts

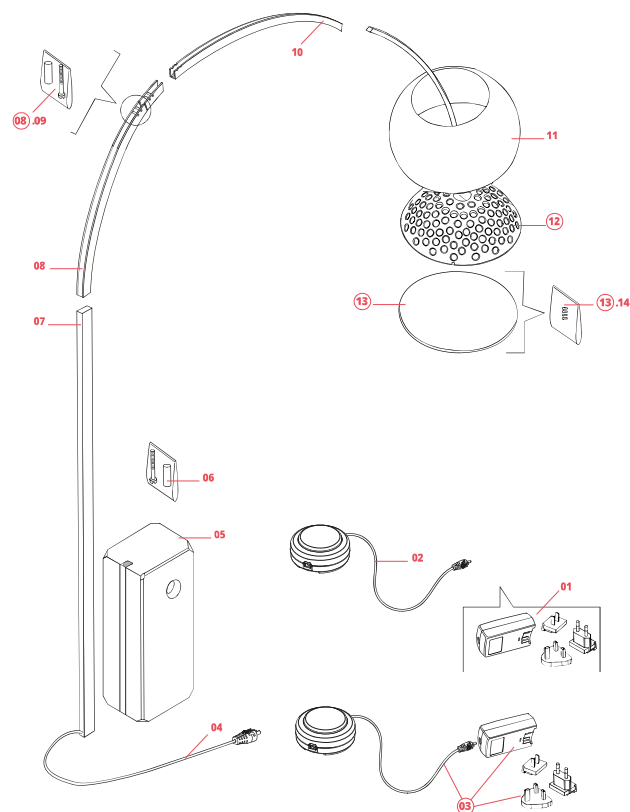

01.	Black plug assembly kit & 48V driver	RF6600130
02.	Arco Led Switch dimmer 600Ma for new version	RF26383
03.	Arco Led Switch dimmer 400mA assembly for old version	RF0303600
04.	Arco Led Middle electric cable with connectors	RF20805
05.	Marble base	F0310000
06.	Fixing screw with joint	RF0300100
07.	Inox stem	RF21041
08.	Long inox channel	RF02970
09.	Pins and screw set	RF0300200
10.	Medium inox channel	RF02971
11.	Polished reflector	RF00797
12.	Arco Led Small inox channel with grid and led	RF0303400
13.	Arco Led Optical led diffuser with fixing screws	RF0303200
14.	Arco Led Optical led diffuser with fixing screws	RF0303300



RF6600130  
Black plug assembly kit & 48V driver



RF26383  
Arco Led Switch dimmer 600Ma for new version



RF0303600  
Arco Led Switch dimmer 400mA assembly for old version



RF20805  
Arco Led Middle electric cable with connectors



F0310000  
Marble base



RF0300100  
Fixing screw with joint



RF21041  
Inox stem



RF02970  
Long inox channel



RF0300200

Pins and screw set



RF02971

Medium inox channel



RF00797

Polished reflector



RF0303400

Arco Led Small inox channel with  
grid and led



RF0303200

Arco Led Optical led diffuser with  
fixing screws



RF0303300

Arco Led Optical led diffuser  
fixing screws